

Instructions and Parts List

3M-Matic™

P/N 70-0064-3000-6 Compression Roller Attachment

For use on 3M-Matic™

a20 Adjustable Case Sealer, Type 10700
a70 Adjustable Case Sealer, Type 10700

Purpose of Attachment

When installed on the infeed end of a case sealer, the Compression Roller Attachment applies pressure to the upper corners of the box sides. This pressure holds the edges of the top major flaps together during case sealing.

Specifications

Overall Dimensions (approximate):

Length: 788 mm [31.0 inches]

Height: 175 mm [6.875 inches]

Width: 242 mm [9.5 inches]

Weight:

Packaged: 2.27 kg [5.0 lbs]

Unpackaged: 1.81 kg [4.0 lbs]



WARNING

- To reduce the risk associated with pinch and entanglement hazards.
 - Turn off electrical power before performing any adjustments on the machine.

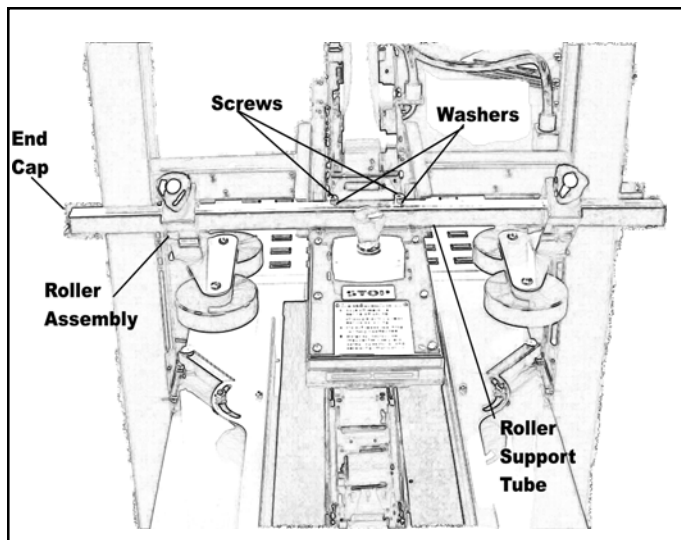
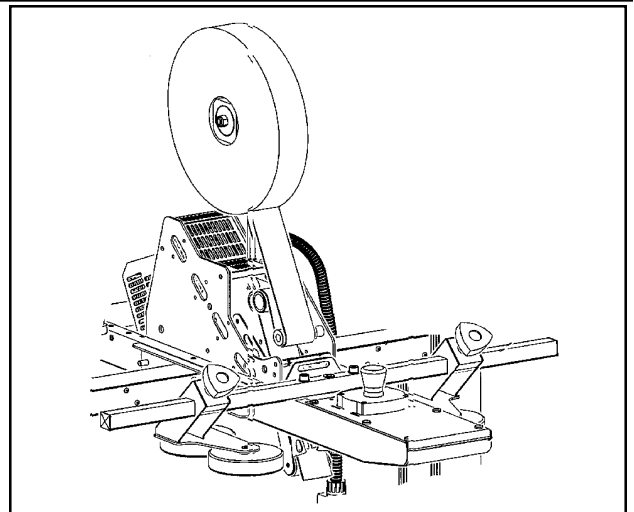

Figure 1— a20 Compression Roller Installation



Compression Roller Attachment Consists of:

Quantity	Description
1	Tube, Roller Support
1	Assembly, Pressure Roller, L/H
1	Assembly, Pressure Roller, R/H
2	Screw, Hex Soc. Hd., M8 x 45 (a20)
1	Screw, Hex Soc. Hd., M8 x 20 (a70)
2	Washer, flat, M8
2	Cap, End

a20 Installation Instructions

1. Align the holes in the Roller Support Tube with those in the upper drive assembly.
2. Using a 6 mm hex wrench, install two M8 x 45 Hex Soc. Hd. screws with M8 washer.
3. Place one Roller Assembly onto each end of the support tube with the rollers toward the inside and the adjustment knobs toward the front of the machine.
4. Place an End Cap into each end of the Roller Support Tube.

a70 Installation Instructions

1. Using a center punch and hammer, break loose the side knockout panels from the upper drive assembly.

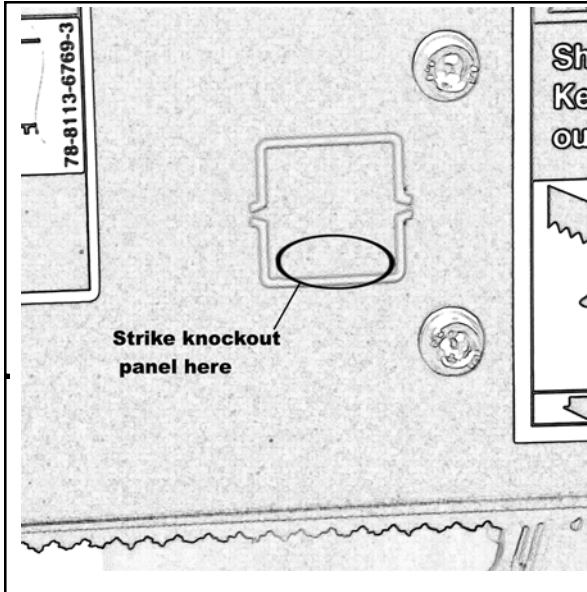

Figure 2—Remove Knockout Panel

2. Grasp the knockout panels with a pliers, twist loose, and remove.
3. Using a 0.5" wide flat file, file down any burrs and sharp edges that may exist inside the knockout hole.
4. Loosen the upper taping head clamp thumb screws. Slide the clamp away from the taping head.

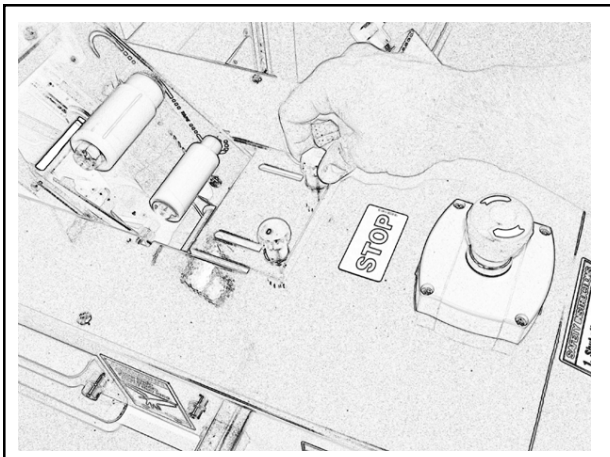

Figure 3—Loosen Thumb Screws

5. Slide the taping head slightly forward and lift out of the upper drive assembly.

6. Using a #2 Phillips screwdriver, remove the drive top cover from the upper drive assembly.
7. Insert the Roller Support Tube through the side knockout holes with the threaded screw hole toward the rear of the upper drive assembly. Align the center screw hole in the Roller Support Tube with the hole in the upper drive assembly.
8. Using a 6 mm hex wrench, install one M8 x 20 hex head socket screw with one M8 flat washer in the Roller Support Tube.

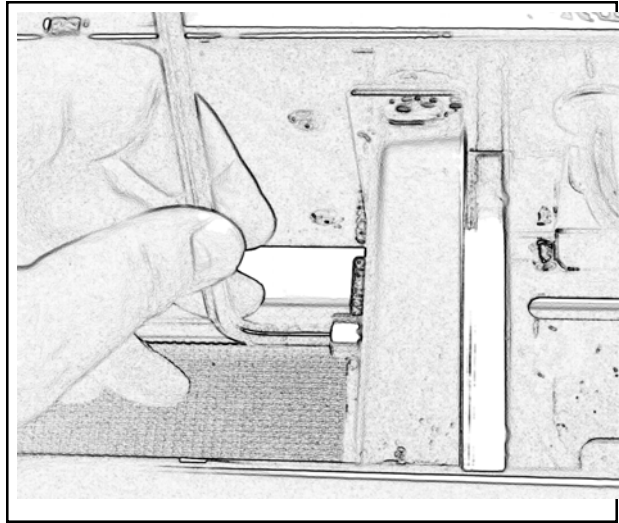

Figure 4—Install Roller Support Tube Screw

10. Place one Roller Assembly on each end of the support tube with the rollers toward the inside and the adjustment knobs toward the front of the machine.
11. Place an End Cap into each end of the Roller Support Tube.
14. Reinstall taping head.
15. Slide the taping head clamp toward the upper taping head and tighten the thumb screws.

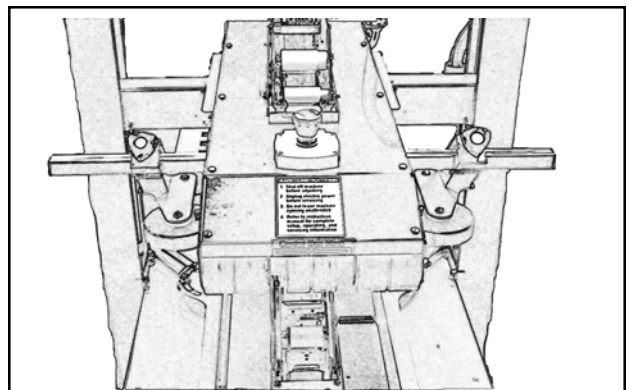

Figure 5—a70 Compression Roller Installation

Adjustment

1. Adjust the Case Sealer for the boxes being sealed as specified in the a20 or a70 Instructions and Parts List manual.
2. Place and center a box in the machine so the leading end extends past the box compression rollers.
3. Adjust the rollers so the separation between them is equal to the finished width of the box. The final position of the compression rollers should be similar to the position of the machine guides.
4. Correct positioning of the rollers enables boxes to move freely through the machine and reduces the gap between the major flaps before tape application.

Replacement Parts List

Ref No.	Part Number	Description
2	78-8137-0630-2	Tube, Roller Support
3	78-8137-0631-0	Assembly, Pressure Roller, L/H
4	78-8137-0632-8	Assembly, Pressure Roller, R/H
5	78-8137-0612-0	Support Roller, L/H
6	78-8137-0613-8	Support Roller, R/H
7	78-8054-8648-3	Roller, Pressure
8	78-8137-0634-4	Bushing
9	26-1001-9843-6	Screw, M6
10	78-8137-0633-6	Knob
11	78-8052-6652-1	Cap, End
12	26-1003-7969-7	Screw, Hex Soc. Hd., M8 x 45 (a20)
13	78-8017-9318-9	Washer, Plain, 8 mm
14	26-1003-7964-8	Screw, Hex Soc. Hd., M8 x 20 (a70)
15	78-8137-0013-1	Compression Roller Safety Label

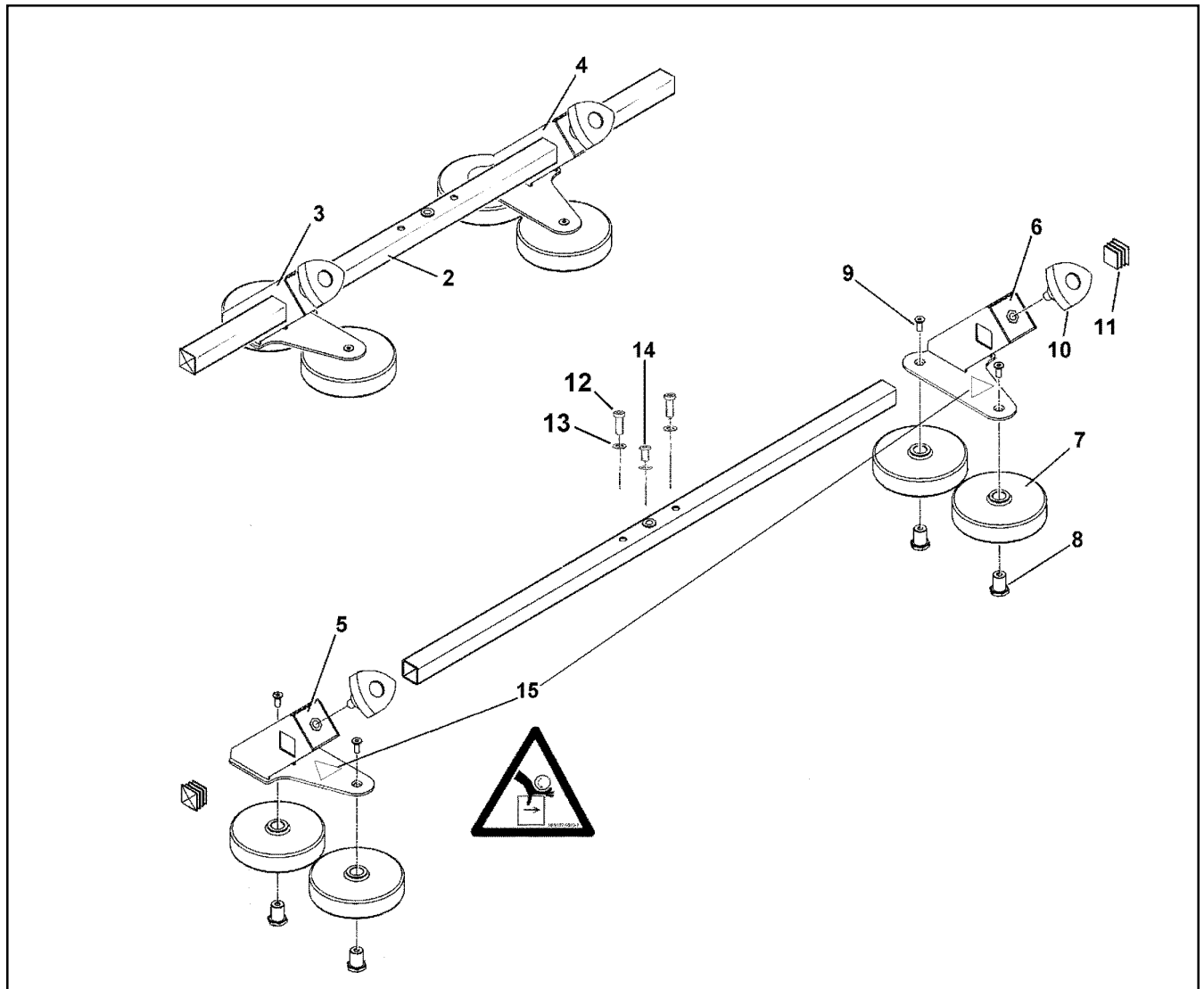

Figure 6—Parts Illustration

How To Order Replacement Parts

1. Refer to Figure 6 to find the required part and reference number.
2. Refer to the parts list for the correct part number.
3. Order by part number, description, attachment part number, and name.
4. Replacement parts and part prices available direct from:

3M Tape Dispenser Parts
241 Venture Drive
Amery, WI 54001-1325
800-344-9883
Fax: 715-268-8153

Minimum billing on parts orders is \$25.00. Replacement part prices available on request.
\$10.00 restocking charge per invoice on returned parts.
Outside the U.S., contact the local 3M subsidiary for parts ordering information.

Equipment Warranty and Limited Remedy: THE FOLLOWING WARRANTY IS MADE IN LIEU OF ALL OTHER WARRANTIES, EXPRESS OR IMPLIED, INCLUDING, BUT NOT LIMITED TO, THE IMPLIED WARRANTY OF MERCHANTABILITY, THE IMPLIED WARRANTY OF FITNESS FOR A PARTICULAR PURPOSE AND ANY IMPLIED WARRANTY ARISING OUT OF A COURSE OF DEALING, A CUSTOM OR USAGE OF TRADE:

3M warrants that its **3M-Matic™ P/N 70-0064-3000-6 Compression Roller Assembly, Type 10700**, will be free from defects for ninety (90) days after delivery. If any part is proved to be defective within the warranty period, then the exclusive remedy and 3M's and seller's sole obligation shall be, at 3M's option, to repair or replace the part, provided the defective part is returned immediately to 3M's factory or an authorized service station designated by 3M. A part will be presumed to have become defective after the warranty period unless the part is received or 3M is notified of the problem no later than five (5) calendar days after the warranty period. If 3M is unable to repair or replace the part within a reasonable time, then 3M, at its option, will replace the equipment or refund the purchase price. 3M shall have no obligation to provide or pay for the labor required to install the repaired or replacement part. 3M shall have no obligation to repair or replace (1) those parts failing due to operator misuse, carelessness, or due to any accidental cause other than equipment failure, or (2) parts failing due to non-lubrication, inadequate cleaning, improper operating environment, improper utilities or operator error.

Limitation of Liability: 3M and seller shall not be liable for direct, indirect, special, incidental or consequential damages based upon breach of warranty, breach of contract, negligence, strict liability or any other legal theory.

The foregoing Equipment Warranty and Limited Remedy and Limitation of Liability may be changed only by a written agreement signed by authorized officers of 3M and seller.



3M Industrial Adhesives and tapes
3M Center, Building 220-5E-06
St. Paul, MN 55144-1000

"3M-Matic" is a registered trademark of 3M,
St. Paul, Minnesota 55144-1000

Printed in U.S.A.

© 3M 2007 44-0009-2067-6(A)