

Instructions and Parts List

3M-Matic™

P/N 70-0064-0377-1 Compression Roller Attachment

For Use On:

"3M-Matic"

110a Adjustable Case Sealer, Type10500

Purpose of Attachment

The Compression Roller Attachment when installed on the infeed end of a case sealer, provides pressure on the upper corners of the box sides. This pressure holds the edges of the top flaps together during case sealing.

Specifications

Overall Dimensions:

Length – XXX mm [XXX inches]
Height – XXX mm [XXX inches]
Width – XXX mm [XXX inches]

Weight:

Packaged – XXX kg [XXX lbs]
Unpackaged – XXX kg [XXX lbs]

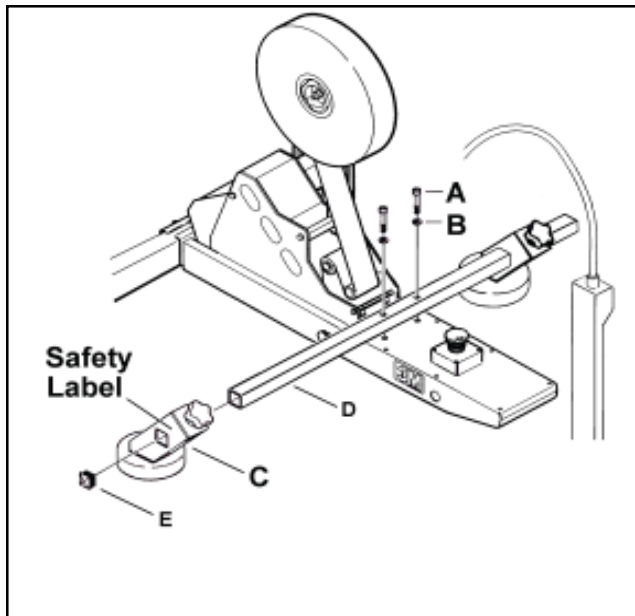
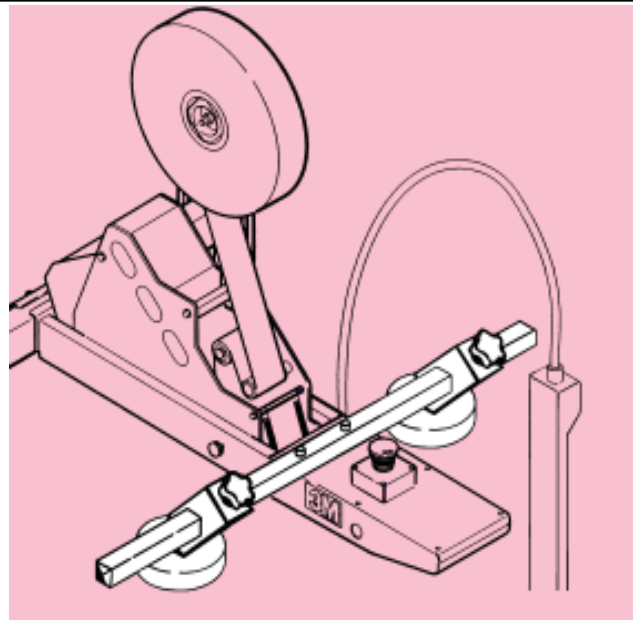

Figure 1 – Conveyor Extension Installation



Compression Roller Attachment Consists of:

Quantity	Description
1	Tube - Roller Support
1	Roller - Assembly L/H
1	Roller - Assembly R/H
2	Screw – Soc.Hd, M6 x 40
2	Washer - triple M6
2	Cap - end



WARNING

- o To reduce the risk associated with pinch entanglement and hazardous voltage.
 - Turn "Off" electrical power and disconnect air supply to the machine before performing any adjustments, maintenance or servicing the machine.

Installation Instructions

1. To attach the compression rollers, refer to Figure 1. Align the the hole in the Roller Support Tube (D) with those in the machine frame. Insert M8 x 40 capscrews (A) with washer (B) and tighten.
2. Place one Roller Assembly (C) on each side of the machine. The safety label located on the side of the assembly should be facing out.
3. Place an End Cap (E) into each end of the Roller Support Tube.

Adjustment

1. Adjust the Case Sealer for the boxes being sealed (Refer to the 110a Instructions and Parts List).
2. Place a box in the machine so the leading end extends past the box compression rollers.
3. Adjust the rollers so the separation between them is equal to the finished width of the box. The final position of the compression rollers should be similar to position determined by the machine guides set in step 1.
4. Correct positioning of the rollers will allow the box to move freely through the machine and reduce the gap between the major flaps before the tape is applied.

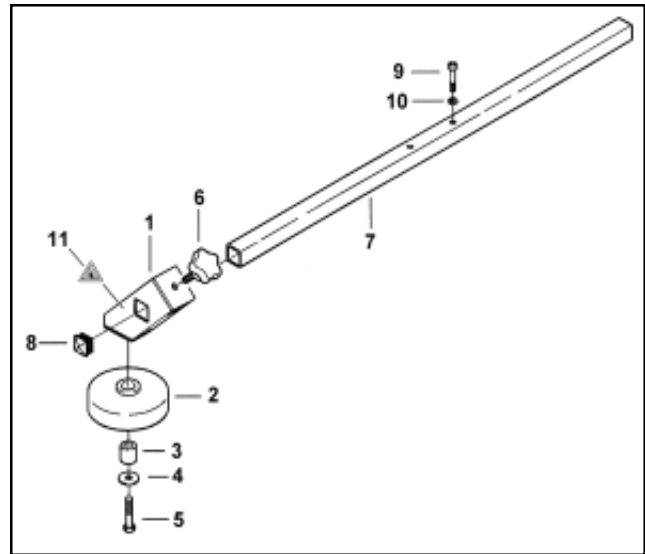

Figure 2 - Parts Illustration

Replacement Parts List

Ref No.	Part Number	Description
1	78-8129-6414-2	Support - Roller
2	78-8054-8648-3	Roller - Pressure
3	78-8055-0622-3	Bushing
4	78-8052-6703-2	Washer - Special
5	26-1003-5845-1	Screw - Hex Hd. M8 x 40
6	78-8129-6155-1	Knob
7	78-8129-6415-9	Tube - Roller Support
8	78-8052-6652-1	Cap - End
9	26-1003-7962-2	Screw - Soc.Hd, M6 x 40
10	78-8042-2919-9	Washer - Triple, M6
11	78-8137-0013-1	Label - Safety

How To Order Replacement Parts

1. Refer to parts illustration Figure 2 to find part needed and reference number.
2. Refer to parts list for correct part number.
3. Order by part number, description, attachment part number and name.
4. Replacement parts and part prices available direct from:

3M/Tape Dispenser Parts

241 Venture Drive 800/344 9883
Amery, WI 54001-1325 FAX #715/268 8153

Minimum billing on parts orders will be \$25.00 – Replacement part prices available on request.
\$10.00 restocking charge per invoice on returned parts.

Note: Outside the U.S. contact the local 3M subsidiary for parts ordering information.

Equipment Warranty and Limited Remedy: THE FOLLOWING WARRANTY IS MADE IN LIEU OF ALL OTHER WARRANTIES, EXPRESS OR IMPLIED, INCLUDING, BUT NOT LIMITED TO, THE IMPLIED WARRANTY OF MERCHANTABILITY, THE IMPLIED WARRANTY OF FITNESS FOR A PARTICULAR PURPOSE AND ANY IMPLIED WARRANTY ARISING OUT OF A COURSE OF DEALING, A CUSTOM OR USAGE OF TRADE:

3M warrants that its **3M-Matic™ P/N 78-8069-3924-1 Conveyor Extension Attachment, Type 19000**, will be free from defects for ninety (90) days after delivery. If any part is proved to be defective within the warranty period, then the exclusive remedy and 3M's and seller's sole obligation shall be, at 3M's option, to repair or replace the part, provided the defective part is returned immediately to 3M's factory or an authorized service station designated by 3M. A part will be presumed to have become defective after the warranty period unless the part is received or 3M is notified of the problem no later than five (5) calendar days after the warranty period. If 3M is unable to repair or replace the part within a reasonable time, then 3M, at its option, will replace the equipment or refund the purchase price. 3M shall have no obligation to provide or pay for the labor required to install the repaired or replacement part. 3M shall have no obligation to repair or replace (1) those parts failing due to operator misuse, carelessness, or due to any accidental cause other than equipment failure, or (2) parts failing due to non-lubrication, inadequate cleaning, improper operating environment, improper utilities or operator error.

Limitation of Liability: 3M and seller shall not be liable for direct, indirect, special, incidental or consequential damages based upon breach of warranty, breach of contract, negligence, strict liability or any other legal theory.

The foregoing Equipment Warranty and Limited Remedy and Limitation of Liability may be changed only by a written agreement signed by authorized officers of 3M and seller.



3M Packaging Systems Division

3M Center, Building 220-8W-01
St. Paul, MN 55144-1000

"3M-Matic" is a registered trademark of 3M,
St. Paul, Minnesota 55144-1000

Litho U.S.A.

© 3M 2001 34-7004-XXXX-X(A)

